

Optowire Fitting Tools

Traverse CT-20

The **Traverse CT-20** is a galvanized steel armament which allows you to fix up to 20 network and connection lines on wooden or metal posts. Its unique profile has been studied with the aim of offering a universal armament allowing it to cover all fixing configurations:

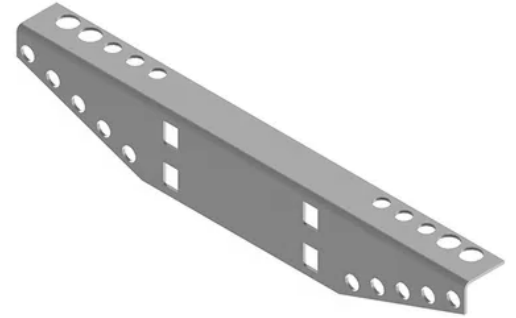

TECHNICAL SHEET

DESCRIPTION	DATA
Material	Zinc
Breaking load, KN	20
Hole diameter for anchor clamps, mm.	17
Pole hole diameter, mm.	16
Width of the grooves of the platform for steel tape, mm.	22
Weight $\pm 10\%$, g.	1100
Installation temperature, °C	-60 to 70